

Other material needed:  
1/4-20 x 3" long allthread rod.  
Two 1/2" diameter by 1/4" thick knurled knobs  
with 1/4-20 internal threads.  
Two medium weight springs 1/2" in diameter to fit  
over 7/16" guide rods.  
Two 7/16" guide rods 3" long from drill rod.  
Two pieces of polycarbonate 3.5" square.

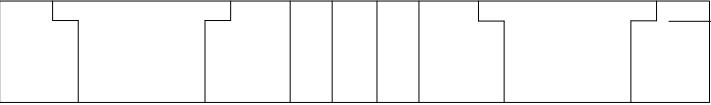

counter bore  
0.130 deep for  
flanged bushing.  
Bushing is 0.650 od  
and 0.4375 id.

Guide rails are 0.4375 od

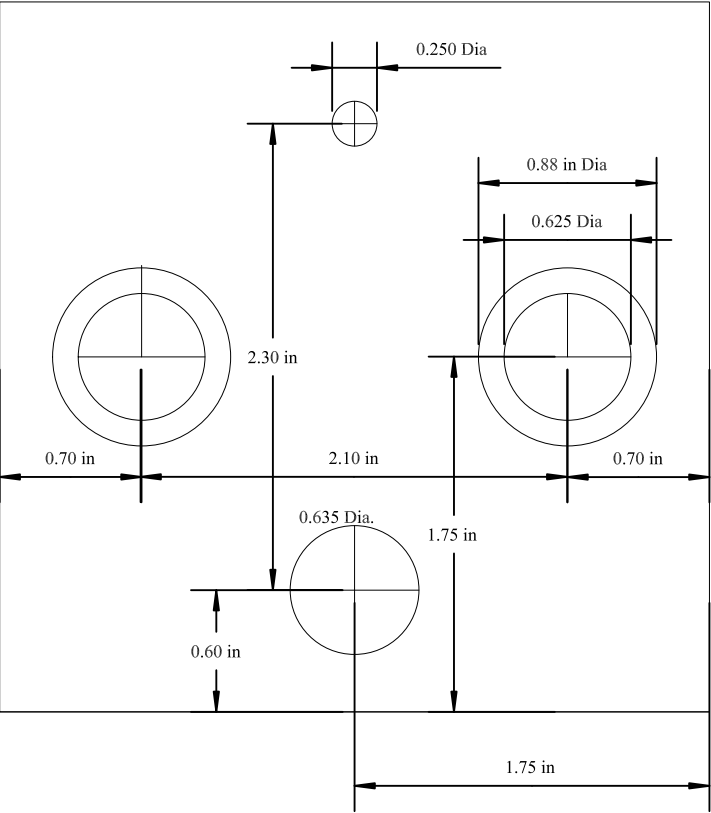

The drawing is shown  
from the bottom side.  
This is the top plate  
and carries the dremel.

Dremel mounting thread.  
3/4-12. Tap is expensive  
however it is not that hard to  
make one on the lathe. Polycarbonate  
is not that difficult to thread.

