

Specifications of American Standard Spindle Noses

Listed below are the various dimensions, per ASA Standards Bulletin B 5.9-1960, to assist in selecting the proper Direct Mount Lathe Chuck.

Spindle Type "A-1"

Type "A"—Short Taper
Type "D"—Camlock
Type "L"—Long Taper

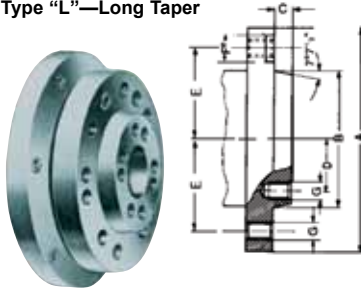

Spindle Nose Size	A	B +0.005	C -0.001	D	E	F +0.002	NC-3
A1-5"	5-1/4	3.2505	.5625	1.2187 +0.006	2.0625 +0.006	.6525	7/16-14
A1-6"	6-1/2	4.1880	.625	1.625 +0.006	2.625 +0.006	.750	1/2-13
A-1-8"	8-1/4	5.50075	.6875	2.1875 +0.006	3.375 +0.006	.9375	5/8-11
A1-11"	11	7.75075	.750	3.250 +0.008	4.625 +0.008	1.125	3/4-10
A1-15"	15	11.251 +0.01	.8125 -0.002	4.875	6.500	1.375	7/8-9
A1-20"	20-1/2	16.251 +0.01	.875 -0.002	7.250	9.125	1.625	1-8
A1-28"	28-1/2	23.001 +0.01	1.000 -0.001	10.4375	12.75	2.000	1-1/4-7

Threaded Type Spindle



To order, specify diameter of thread and pitch of thread.

Camlock-Spindle Type "D-1"

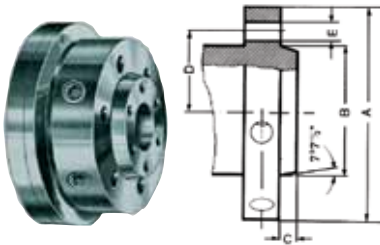

Spindle Nose Size	A	B	C	D	E +0.002
D1-3"	3-5/8	2.1250 +0.00025	7/16	1.391 +0.002	.5937
D1-4"	4-5/8	2.5005 +0.0005	7/16	1.625 +0.003	.6562
D1-5"	5-3/4	3.2505 +0.0005	1/2	2.0625 +0.003	.78125
D1-6"	7-1/8	4.1880 +0.0005	1/2	2.625 +0.003	.90625
D1-8"	8-7/8	5.50075 +0.0005	5/8	3.375 +0.003	1.03125
D1-11"	11-3/4	7.75075 +0.0005	11/16	4.625 +0.006	1.21875

Special Order

We can special order "A" or "D" spindle to "A" Chuck adapters. Call us with your machine spindle and chuck mounting, i.e. A-8 spindle to A-6 chuck, or D-8 spindle to A-6 chuck.

Long Taper Key Drive Type "L"

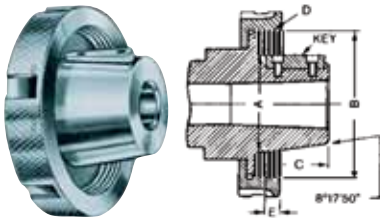

Spindle Nose Size	A +0.002	B	C	D	E	KEY
L00	2.750	3.745	2	6TPI	9/16	3/8 x 3/8 x 1-1/2
L0	3.250	4.496	2-3/8	6TPI	5/8	3/8 x 3/8 x 1-3/4
L1	4.125	5.996	2-7/8	6TPI	3/4	5/8 x 5/8 x 2-3/8
L2	5.250	7.745	3-3/8	5TPI	1	3/4 x 3/4 x 2-7/8
L3	6.500	10.370	3-7/8	4TPI	1-1/8	1 x 1 x 3-1/4

KCM adapters, made in the USA, can be manufactured as to thickness, diameter, or other specifications according to your special order. Call us with your requirements.

German Standard Type DIN 55027

This spindle nose is provided with short tapered flange like the American spindle noses type A-1 and D-1. In its face this spindle nose has a number of holes (3, 4 or 6) into which the lock studs of the chuck can be inserted. The locking is made by bayonet clutch.

Dimensions Inches

Spindle	d1	d2	d4	d5	No. of Holes	d9 H8	l1	l2
DIN 3	4.02	2.125	2.9528	.83	3	—	.63	.433
DIN 4	4.41	2.5005	3.3465	.83	3	.56	.78	.433
DIN 5	5.31	3.2505	4.1260	.83	4	.63	.86	.512
DIN 6	6.69	4.1880	5.2520	.91	4	.75	.98	.551
DIN 8	8.65	5.5007	6.7480	1.14	4	.94	1.11	.630
DIN 11	11.42	7.7507	9.2520	1.42	6	1.13	1.38	.709
DIN 15	15.74	11.251	13.0000	1.69	6	1.37	1.65	.748

